



Bourdon Tube Pressure Gauges

For U-Clamp Panel Mounting
ABS Plastic Case / Copper Alloy Wetted Parts
Fits Metric and U.S. size (1½" & 2") Panel Cutout
Type 111.16

Pressure Gauges

Application

Gas or fluid which does not clog connection port or corrode copper alloy. Example: air pumps, pneumatic systems, compressors, water and heating systems.

Sizes (All sizes not stocked)

1½", 2", and 2½" (40, 50 and 63 mm)

1½" & 2" size: Fits metric or U.S. size panel cutout

2½" sizes: Fits metric size panel cutout

Accuracy

± 3/2/3% of span

Ranges (All ranges not stocked)

Vacuum / Compound to 30"HG / 0 / 200 PSI

Pressure from 15 PSI to 6000 PSI

or other equivalent units of pressure or vacuum

Working Range

Steady: 3/4 of full scale value

Fluctuating: 2/3 of full scale value

Short time: full scale value

Operating Temperature

Ambient: -40°F to 140°F (-40°C to 60°C)

Media: max. 140°F (+60°C)

Temperature Error

Additional error when temperature changes from reference temperature of 68°F (20°C) ±0.4% for every 18°F (10°C) rising or falling. Percentage of span.



Standard Features

Connection

Copper alloy

Center back mount (CBM)

1/8" or 1/4" NPT

Bourdon Tube

Material: Copper alloy

30"Hg (Vac.) to 600 PSI - C-type

800 PSI to 6000 PSI - helical type

Movement

Copper alloy

Dial

White plastic with stop pin and black lettering

Pointer

Black ABS plastic

Case

Black ABS plastic with integral profile ring

Black ABS with ABS panel adaptor ring and stainless crimped profile ring (2" U.S. size panel mount version only)

Standard Scale

PSI

Window

Snap-in acrylic

U-Clamp Bracket

Zinc-plated steel with two zinc-plated slotted screws

Order Options

Front flange

Crimped stainless steel profile ring

Custom dial layout

Brass restrictor

Special connection limited to wrench flat area

Clean for oxygen service

Other pressure scales available:

Bar, kPa, MPa, Kg/cm² and PSI

APM 111.16
(APM 01.10)

Standard & Metric U-clamp version

Dimensions:

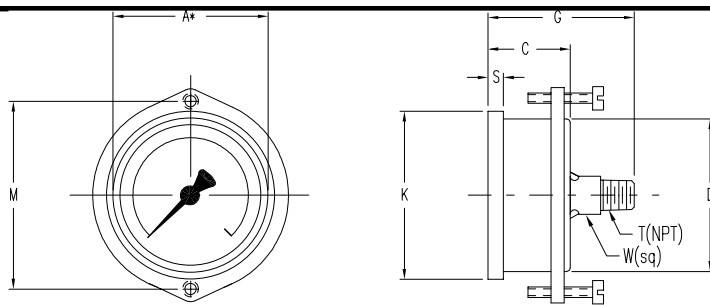

A* NOMINAL SIZE

TYPE/SIZE	WEIGHT	KEY	A*	C	D	G	K	K1	M	S	S1	T	W
111.16 1.5" CBM/UC	0.18 lbs.	mm	40	26.	41	45	45	46	48	4.5	5.5	1/8" or	14
		in	1.5	1.0	1.6	1.77	1.77	1.8	1.8	0.18	0.2	1/4" NPT	.55
111.16 2" CBM/UC	0.23 lbs.	mm	50	26.	49.	46	54	55	57	4.5	5.9	1/8" or	14
		in	2.0	1.0	1.9	1.81	2.13	2.1	2.2	0.18	0.2	1/4" NPT	.55
111.16 2.5" CBM/UC	0.24 lbs.	mm	63	29.	63	49	68	--	70	4.7	--	1/8" or	14
		in	2.5	1.1	2.4	1.93	2.68	--	2.7	0.19	--	1/4" NPT	.55

- (1) For gauges with 1/8" NPT connection, subtract 0.08 in. (2 mm) from "G" dimension.
 (2) For gauges with optional crimped metal ring, dimensions K1 and S1 replace K and S.

2" U.S. size Panel Gauge

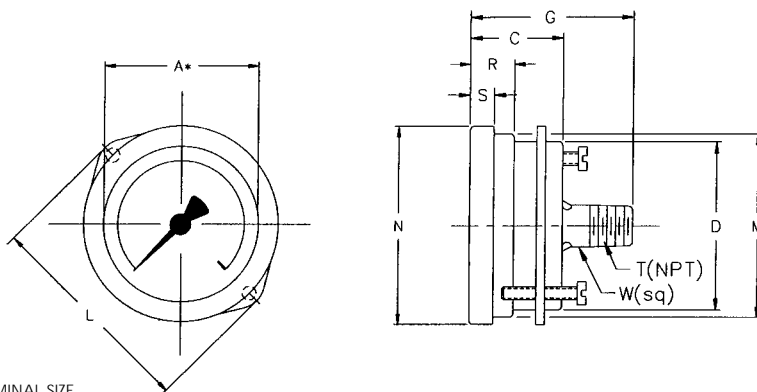

A* NOMINAL SIZE

TYPE/SIZE	WEIGHT	KEY	A*	C	D	G(1)	J	L	M	N	R	S	T	W
111.16P 2"	0.33 lbs.	mm	50	27.4	49.5	48	66	57	53.3	57.7	13	7.1	1/4" NPT	14
		in	2.0	1.08	1.95	1.89	2.60	2.24	2.1	2.27	.51	.28		.55

- (1) G dimension changes to 45 mm / 1.77" with 1/8" NPT connection.

2½" U.S. size Panel Gauge

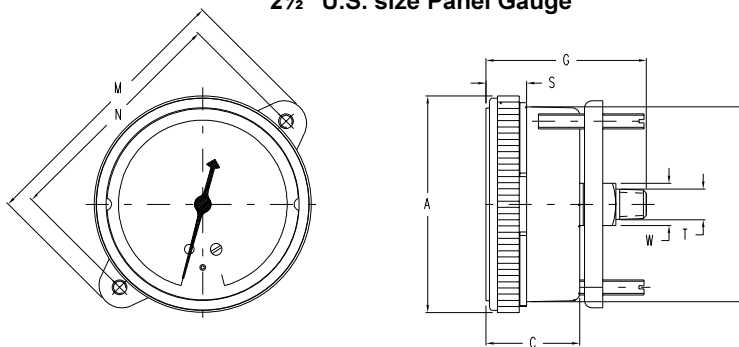

A* NOMINAL SIZE

TYPE/SIZE	WEIGHT	KEY	A*	B	C	G ¹	M	N	S	T	W
111.11P 2½" CBM/UC	0.30 lbs.	mm	72.4	65	31	56	91	78	13.5	1/4" NPT	14
		in	2.85	2.56	1.22	2.20	3.58	3.07	0.53		0.55

- ¹ G dimension changes to 53 mm (2.09 in.) with 1/8" NPT connection.

Panel cutout = "E"
dimension + 1.0
mm (0.04 in.)

Ordering Information:

State computer part number (if available) / type number / size / range / connection size and location / options required.

Specifications given in this price list represent the state of engineering at the time of printing. Modifications may take place and the specified materials may change without prior notice



WIKAL Instrument Corporation

1000 Wiegand Boulevard

Lawrenceville, Georgia 30043-5868

Tel: 770-513-8200 Fax: 770-338-5118

<http://www.wika.com> e-mail: info@wika.com